

## Introduction

### ► Feature

- Line pull: 1,814 kg / 4,000 lb synthetic rope first layer
- Synthetic rope: 5.5 mm x 15.2 m synthetic rope
- Brake: Mechanical and dynamic brake for 100% braking
- Clutch: Turn for free spool
- Control: Handlebar mounted rocker switch

### ► Unpacking

- Winch assembly..... 1 pc
- Handlebar rocker switch kit..... 1 pc
- Hawse fairlead..... 1 pc
- Synthetic rope w/hook..... 1 pc
- Contactor pack ..... 1 pc

### ► Read this manual carefully

Carefully read and understand this manual before operating the winch. Careless winch operation may result in personal injury, danger to others and or damage to property

### ► Information requesting or parts ordering

Please specify the followings information:

- Winch PN
- Part description
- Quantity for each part
- Serial number
- Replacement part number

# Installation

Before using the winch ensure all electrical components are in good condition and all connections are sound.

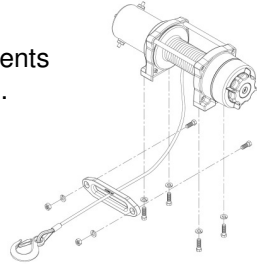

## ► Synthetic rope replacement

- It is very important that the winch will be mounted on a flat and hard surface of mounting channel in order to make sure the motor, drum and gearbox housing are aligned correctly.
- Hawse fairlead does not mount to winch directly.
- The synthetic rope shall be wound in an under-wound orientation only.
- Four (4) M8 x 25L 8.8 grade high tensile steel bolts must be used in order to sustain the loads imposed on the winch mounting.
- Two (2) M8 x 20L 8.8 grade high tensile steel bolts must be used for fastening the hawse fairlead into the mounting channel.

## ► Wiring Diagram

Attach the black lead firmly to the negative (–) battery terminal and red lead to the positive (+) battery terminal. The voltage drop for the winch motor must not exceed 10% of the nominal voltage of 12V DC.

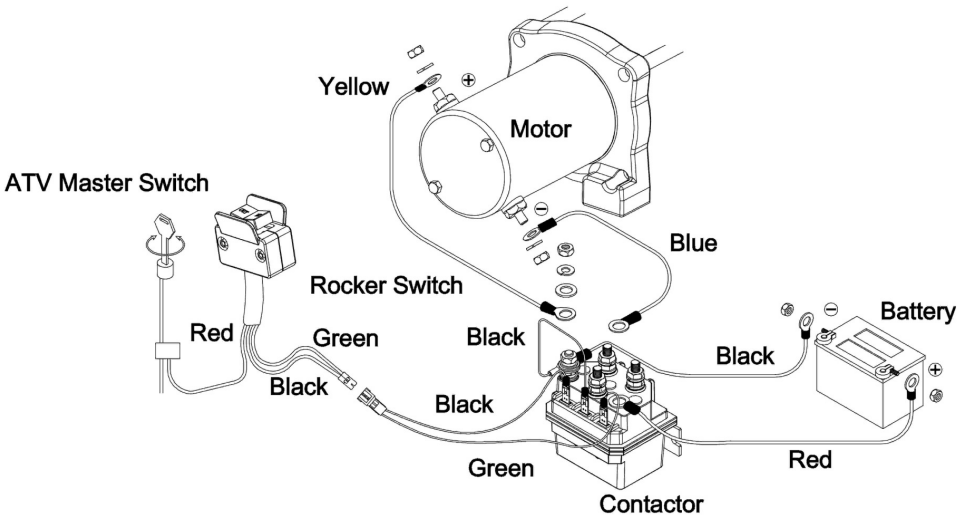

## ► Nut fastening for motor & contactor

1. Holding the lower nut on the stud, tighten the upper nut clockwise.
2. The torque setting for nut is 5.7 N-m / 50 lb-in.

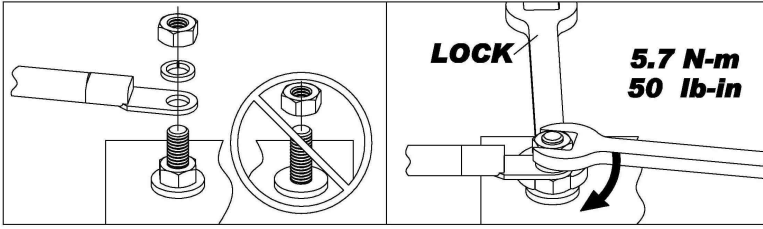

## Warning

- The winch is not to be used for transporting or lifting of personnel.
- The rated line pull shown is based on the first layer of rope on the drum.
- The rope shall remain with at least 5 wraps on the drum at all times

## Handlebar Rocker Switch Mounting

Handlebar mounted rocker switch can be operated without removing your hand from the grip.

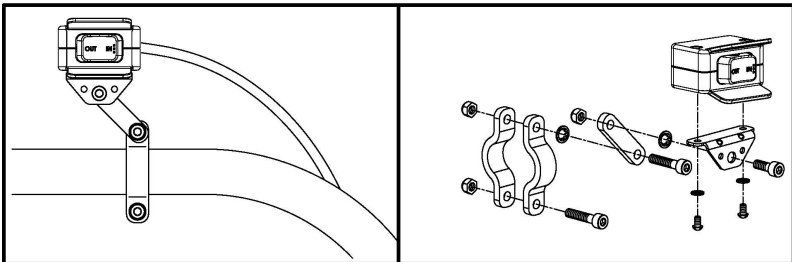

# Parts List

| Item No. | Description                   | Part No. | Qty |
|----------|-------------------------------|----------|-----|
| 1        | Motor w/housing               | 881331   | 1   |
| 2        | Motor couple kit              | 880988   | 1   |
| 3        | Drum bushing                  | 880990   | 2   |
| 4        | Drum kit                      | 881006   | 1   |
| 5        | Tie bar kit                   | 881007   | 1   |
| 6        | Tie bar kit                   | 881008   | 2   |
| 7        | Gearbox support rack          | 880994   | 1   |
| 8        | 3 <sup>rd</sup> stage carrier | 880995   | 1   |
| 9        | 2 <sup>nd</sup> stage carrier | 880996   | 1   |
| 10       | 1 <sup>st</sup> stage carrier | 881009   | 1   |
| 11       | 2 <sup>nd</sup> ring gear kit | 880998   | 1   |
| 12       | 1 <sup>st</sup> shaft kit     | 881010   | 1   |
| 13       | Gear box kit                  | 881000   | 1   |
| 14       | Clutch base                   | 881011   | 1   |
| 15       | Friction block                | 881012   | 1   |
| 16       | Clutch lever kit              | 881013   | 1   |
| 17       | Shifter kit                   | 881001   | 1   |
| 18       | Synthetic rope w/hook         | 881953   | 1   |
| 19       | Hawse fairlead                | 881072   | 1   |
| 20       | Contactork pack               | 881037   | 1   |
| 20-1     | Contactork w/leads            | 881385   | 1   |
| 20-2     | Battery lead (+)              | 880234   | 1   |
| 20-3     | Battery lead (-)              | 880235   | 1   |
| 20-4     | Motor lead (yellow)           | 880236   | 1   |
| 20-5     | Motor lead (blue)             | 880237   | 1   |
| 21       | Handlebar rocker switch kit   | 881003   | 1   |
| 22       | Mounting hardware             | 881005   | 1   |
| 23       | Handlebar hardware            | 880242   | 1   |
| 24       | Handsaver strap               | 880026   | 1   |
| 25       | Cable tie                     | 880243   | 1   |

# Winch Assembly

